

OMUKWETU

Registered at the General Post Office as a Newspaper

15c

Hausshiku mewilikongeleka

Omubisofi Bonifatius Hausshiku odalele yoKavangc noye omudalelwamc wotete Omunamibia wongeleka yaKatolika kaRocma, okwa yapulilwa oshilonga shoubisofi. Omutekeli waye oye Rudolf Koppmann oc a wilika ongeleka ei eedula dihapu. Omclwoukulupe oshilonga osha pewa omunyasha ou a twikile kc.

Osha li potundi 9 yongula yoSocndaha eti 15Maalitsa 1981, eshi eengedjo diyapuki da li tadi ningi omalufo keeshungu dile dcongeleka ya lukilwa Maria Omuyapuki mCvenduka. Omhepo youkwashivilo oya ngungumaneke ongudu inene ya li ya ongala mcngelika nopondje. Omapandela omanene nomanini okwali taa denge omake kumwe mckufimaneke ounene wefiku olo. Omusholondoc wovabisofi omc mwa mcnika oshipala shomubisofi Kauluma waAnglican nomubisofi Dumeni wa ELOK, owa li tau katuka nokupitila mcshinyanga oshiyapuki.

Enangeko ola ningwa komubisofi munene E.Cassidy, omukalelipo womupapa. Oha di koPretoria. Cassidy naKoppmann ova kwata Hausshiku mcmaoko keshe umwe okombinga yaye, ndele tave mu tula molukalwa liyapuki. Osho ngaha Hausshiku a pewa ewiliko longeleka yaKatolika kaRooma muNamibia alishe.

Oshipopiwa shaye paxupi osha li ngaha: "Mokulongekida oshipopiwa eshi shefiku eli, omadiladilo ange ctaa i tete kuKalunga. Luhapu onda indila omushiyakano nomutenge ou u pitilile nge po, u pewe mukwetu umwe. Nandc ongha ohandi mu pandula amshe eshi tamc yambidida nge. Olutivali omadiladilo ange ohandi a twala komupapa ou e lineekelela nge oshilonga eshi. Ohandi pandula yo unene elongelokumwe lovabisofi aveshe mu South Africa nomuNamibia nonda hala li twikile.

Omubisofi Hausshiku okwa pandula omutekeli waye Koppmann nokwa holola kutya mewiliko laKoppmann ovakriste cvaKatolika ova hapupala. Okwa tungifa yo cipangelo neefikola. Omatumbulo taa landula okwe a popya nomufindc: "Tu longeleni kumwe cpo lu fimaneke Kalunga notu lalakanene cuwa wovanhu aveshe nopehe na ondjoolola. Omubisofi Hausshiku okwa ti ota kendabala pamadiladilo a Jesus eshi ta ti: "Omcna womunhu ine uya okulongelwa, ndelenee okulongela. Okwa koleka epopifo laye nomatumbulo a kufwa: Mu 1Kor 16:13-14. Di Lileshela. Pexulilo omubisofi Hausshiku okwa lombwela ovapwilikini kutya ashishe na shi ningwe MEITAVELO KOMCHOLE.

lita yaTaagona

Esiku eti- 2 lyaOktoba1980, meme Hileni Iingula ngcka ta longo mEtumo kOnakali, ckweya komutonatelishitayingeleka shC-ndcnga, Festus Ashipala nokumeme Else Witting. Oshipala she osha li tashi u-like kutya ope na shcka she mu etele u-dhigu noluhodhi. "Oshike mtela she enda ko? olyo epulo lya penduka mcmadhila... dhilo gaamboka ye mu shi.

Meme Hileni okwa holola uudhigu we pwaa na omaongaongc niitya mbika: "Aakwetu sho nde enda ngeyi ondi nauudhigu note kongc ekwatho. Oku na Omukulukadhi gwokOnakalunga a li a mcno ckanona, ihe okwa hulitha ocndjenda, Bethimbo lyokupulumutha kwe. Okanona oko ke li ke na omwenyo. Onda hala mu ke ka tale ko, opo mu ka paluthe ka kale ke na omwenyo. He ya ko cmupagani, ihe yina okwa shashwa. Ngashingeyi okanona oke li ashike miika ha yAayamba yalwe yaahoka, ya tegelela ndje. Ileni tuyeni yakwetu. Tweendelele ni! osho meme Hileni a ti noshipala shaa na ombili.

Meme Else Witting okwi indile ndje tu ye pamwe nayek kOnakalunga. Hileni atete-kele, manga tse tatu landula ko. Otwe ya adha ya tegelela pookamba dhaNalunike. O Ctwathigi oshihauto shetu mpoka notwa yi mwaashoka shawo. Oshoka omclwomithitu, okatuukala ketu itaka piti, omavugu oranene noonkondo.

Cshihauto csha li tashi hngwa okati ka lala ihe itatu thiki nando. Huginina osho ngaa twa ka thika. Eeno shili, "koku-le ihaku thikwa ngula"

Mokuthika otwa adha aantu opo ya z... komayendc. Ngame onda endelele okupu- la: "Okanona oke li peni? "Onda li nuumbamba kutya pamwe okapakwa nayina. Eyamukulo clya ti okanona oke li me- tsali mcka! Opo ihe omutima kololo, nda fudha. 'Otwe ya popitha nChapu yaKalunga, Joh. 11: 25-27" Jesus otaka yumudha wo nAyelele mboka ye mu itaala ya ye mcmwehyo gwaaluhe.

Konima yomapopitho nomagalikaneno, aakulukadhi oye tu lomtwele kutya okanona otwe ka ningila egundji, opo mu ka adhe ke na omwenyo. Otwe ya pandula noonkondc, oyo noye tu pe o- mumati gwetu. Ihe manga inatu za ko na ko, onda pula he yokanona omusa- mane Taangcna kutya edhina lyokanona olini? "Iita. Onda ka luku Iita cshoka oka valwa mclugcdhi ndcka lwa falele yina. Onda mu pula ishewe: " Ngele ka thiki kCnandjokwe noke na o- kushashwa, edhina lya ko otali ningi lye? Tate Taangcna okwa ti: "Naka shashwe Iosea Iita

Otwa zi ko ihe na Iita sigc cposhihauto shetu nameme Else notwi idhenge mela lyondjila okugalukila kCnandjokwe. Ngame onde ende nda papata Iita, ngame otandi imbi eimbi 534 noku mu yamutha kegundji ndyoka twa yile na lyo, manga meme Else ta lyata omahoc- li.

Iita okwa thiki mOnandjokwe eti-2lya- Oktoba1980. Okwa taambwa kuMatrona, meme Kristi Pakkala, ngcka e mu fala

OMUMVO

GWEI TAALO

Nuumvo ctwa peweni omumvo gweitaalo. Pamadhiladhilo gandje, ngele omuntu to tala nckukonakona nawa omumvo gwa yi (gweilongc), pamwe nomumvo gwonomvo (gweitaalo), konyala oto mcno kutya omadhiladhilo gadho kage lyaathane kokule unene. Omclwashike mbela? Oshoka konyala olwindji eitaalo cta li zimelongo. Nandi gandje oshiholelwa. uuna omuntu e li nando cmosikola yekoleko nenge yeshasho, nena omuntu a tya ngeyi ota longwa shike? Eyamukulo efupi mbela, ota longwa ckwiitaala. Ano shono ta longwa otashi vala eitaalo. Shimwe ashike otashi vala eitaalo uuna nakulongwa ta dhiginine nokwa taamba ashihe shoka ta longwa nomwenyo aguhe. Na eitaalo lya tya ngeyi cta cli na iilonga. Na oli na wo oku ya miilonga, lyi longe. Onkee nda ti elongo neitaalo konyala oshinima shimwe. Uuna wa longwa oto itaale, na uuna wi itaale, oto yi ihe miilonga (to longc) neitaalo.

Nandi ye mcomumvo gweitaalo. Elongc ndjono wa longo nenge wa longwa omwazi tuu eitaalo? Na eitaalo ndjono twa pewa nuumvo tu li konakone ou li nalyo ngiini? Omuyapostoli Paulus ote li popi nawa sho tati: Eitaalo clyo einekelo lya kcla-----Hebr.11:1. Eitaalo clyo tali fala kehupitho. Omwiitaali ke na ekwatathano nuulunde.

Natu tale coitaali yamwe, tse tu tale wo eitaalo sho hali longo iikumitha. Eitaalo clyo lyahupithitha alumentu

yatatu meziko lyomulilo paDan3:1-33.

Eitaalo clyo lya hupitha Daniel mekclolo lyoonime. Dan.6:1-18. Eitaalo clyo lya tokolitha Abraham a gandje po cmwana awike(epcna) Isaak omefikilondjambo.

Eitaalo clyo lya koleke nolya tsu Job omukumc muudhigu wa li we mu adha. mombimbeli otatu lesa aantu (oitaali) oyendji mtono ya hupithwa, ya aludhwa, ya mangululwa mcondholongc noya yumudhwa nokuli meso lyolye-nelyene, omolweitaalo lyawo. Eitaalo ctali longo iikumitha shili.

Aaholike, otu li pethimbo tali pula notali pumbwa eitaalo. Ethimbo lyongashingeyi otali pula shili omwenyo gwiitaala. Kalunga pa mwe okwe tu peni ethimbo edhigu lya tya ngeyi, opo a tale eitaalo lyetu. Onawa sho twa peweni wo mcomumvo gu na oshipalanyolo sheitaalo. Eitaalo ndino ctu li nalyo ngiini pethimbo ndino? Pamwe eitaalo lyetu clyo ndjoka lyaa na iilonga. Tashi ti, eitaalo lya sa.

Oshigwana shaNamibia oshihclike, oshili otwa pumbweni eitaalo lya kola. Uuna tu na eitaalo enkundi nena itatu vulu sha mekon-djo ndika. Oshoka ekondjo lyaa na eitaalo clyowaleelela. Iiningwanime tayi ningwa pethimbo ndika otayi pula ashike eitaalo. Omadhengc, omahepekc gi ili ngi ili, omayedhililo gmccondholongc, okuyonwa po kmalikc ninima iikwawo ya fa mbika, ayihe otayi pula notayi pumbwa ashike eitaalo.

Ocitaali olundji otaa dhimbululwa momaudhigu. Ongele cgwc ngcno nda za nokutu-

dha za kep. 6
Ehumokomeho

Ngaashi sha tseyika nawa, pashiAfri-
ca edhina kehe ctali ti sha. Ngaashi
Nangula otali ti omuntu okwa valwa o-
ngula. Niita nenge Iita, okwa valwa pe-
thimbo lyiita. Omadhina wo gcokuku mbo-
ka ya vala octate (surnames) nage wo
ctaga ti sha go ishewe otaga dhimbu-
lutha nawa omuntu kutya mwene ogwo-
muhoko, nenge ogwoshigwana shini.

Sho ehumokomeho lye ya pamwe nuukriste
mevi lyetu, Omadhina gopomtoga ngaashi
ooNuusiku noCliyambo, oga ethiwa po ya-
mwe otaa ti aniwa ogoshipagani, nando
ogc ashike omadhina gcpashigwana ngaa-
shi naanaa ooMaria, nooPetrus omadhina
gOshijuda ngo twa kutha mCmbimbeli no-
twa tala kutya ogcpakriste. Omadhina
gamwe ngaashi Hilja, tali ti: mwena,
Sirkka tali ti ombahu, Toivo tali ti
etegameno, kage shi andc omadhina gc-
pakriste, ihe ogpasoomi. Edhina kehe
nonandc li kale lya za mCmbimbeli, o-
nkee tuu oli li lyoshigwana shontumba,
kali shi andc lyopakriste. Ehupitho
lyetu otali zi ashike: MCKWIITAALA
JESUS NOKU MU TAAMBA SHILI MCOMWENYO .
DHEU. (Taku tsikilwa)

dha za kep. 3

Omumvo gweitaalo

mbula, nenge pamwe cngele ofamili yo-
ntumba (ndjone yi na eitaalo) ya kani-
tha omuholike gwayc, (a mana oondjenda)
ofamili ya tya ngaaka (yi na eitaalo)
itayi nika uuthigwa nande. Peha lyokuni,
ka uuthigwa shila oto dhimbulula omuku-
mc . Oshoka oye na einkelo netegameno,
lya zi meitaalo, kutya ona ya ka mcna-
thana mukwaaluhe.

Ihe mpoka pwaa na eitaalo, otapu mcnika
notapu dhimbululwa uuthigwa nokwaa me
netegameno. Oshike mbela? Omolwaashoka
inaya itaala no inaya dhimbulula shoka
ye shi ningilwa kutya oshike nosha za
peni. Kaye na eitaalo. Pamwe ctu li mc-
ngundu ndjika?

Aamwameme, manga tu li petameko lela
lyomumvo gweitaalo natu tule eitaalo
miilonga li longe. Omuntu ohc koneke
shoka sha ningwa nale naashoka wa mc-
na nale. "Komeho ihaku nongelwa" oshc
ookuku ya tile. Odho shili. Omumvo
nguno inatutseyeni no inatu tseye ma-
nga kutya otagu ka hula ngiini. Ihe
shono tuokuningeni, okukala ashike
meitaalo. - Elifas Akudhenga

Aaleshi aasimanekwa, mboka
mwa adhikile mwa eta omambo
geni OMAIMBILO NOMBIMBELI
kOshinyanyangidho ga opale-
kwe, manga inaashi yonwa po,
otatu mu tseyithile mpano
kutya gamwe opo ge li ngaa
ga opalekwa noge mu tegele-
la mu ga ile ko.

Onawa ngele to ya okuta-
la, pamwe lyoye olyo lya
hupa po.

Ngele itaga mono ooyene
sigo Mai gwa piti, otashi
vulika taga ka landithwa
po kondando ombwanawa, ku-
mboka haa kala taye ga pula.
Pita po ano uuna to endele
lwahandika, opo u kuthe po
lyoye.

"ONE AMUHE OMALENGA GIITA IYAPUKI "

Eturbulo eli olimwe lomatumbulo omu-
bisofi waELOK, tate K. Dumeni, eshi a
li a popifa oshocngalele shovafita vo-
shitayingeleka shokuningininc. Osha
ongalele okudja 18-21/3/1981, mOkahao.

EKUNDO LOMUBISOFI

Omubisofi eshi a manakuyadja omakundo
kovafita oo a dja apa naapenya, okwa e-
ta yo ekundo laye, la kanghamekwa kee-
ndjovo da dja mu Joh16:33. Okwe di yeli-
fa nomadiladilo opatatu, taa popi oku-
kalamwenyo kwopakriste.

Omubisofi okwa ninga ^{okundolaye} paxupi ta ti: "1)
Okukalamwenyo kwopakriste otashi ti e-
kondjo la taalela efindano. Efindano
eli ovakriste vashili, otave ke li mc-
na ngeenge Jesus te ya. 2) Okukalamwe-
nyo kwopakriste cko iita iyapuki neko-
ndjo okukondjifa eenghono domilaulu.
Mekwatafano noshitwa eshi, okwa pula
epulo tali shilile omunhu melidilulu-
lo ta ti: Eshi, hatu kondjo, ohatu
kondjo tu li peni? Pamwe ohatu kondjo
ongc tu moukumwe naKristus, ndele
mboli hasho?"

Okwa twikila ko vali ta ti: "3) Oku-
kalamwenyo kwopakriste oko: ekondjo,
orahepeko, ncmamakelo. Omubisofi okwa
hulifa ekundo laye nomufindo nonome-
po ye litelela ta ti: "Kaleni mu na
omukumc nombili mekondjo eli..."

OMA SHIVIFU NOYEETWAPO

Omubisofi eshi a xulifa ekundo laye
okwa shivifa oshoongaleleleka osho
tashi kala ko neudc. Okwa yandja yo

cinima imwe kovafita ve i kundafane mc-
shocngalele shavo. Omubisofi okwa ti, ona-
wa ovafita va ninge hava talelepo cilyo
yomaongalo aELOK oyo i li mCushimba nge
pomafudc ile peemhito cimwe.

OVAPOPI VAMWE

Sakeus Hekandjo, omudinini woiniwe ya-
ELOK, naye okwa yelifila yo cvafita nghe-
ne oraongalo a xurra komresho mckwocngela
oimaliwa nomckunda ko nawa okuumba eenga-
lo mraongalo. Sakeus okwa holola yu ku-
tya ekwatafano liwa pokati komudinini
woiniwe meongalo novakwanecngalo, ctali pu-
mbiwa unene, opo meongalo mu kale exumcko-
mesho liwa mciniwe.

Omubisofi okwa li pamwe na tate A. Ha-
sheela na dr. T. Shivute, oc a li yo a
popifa oshoongalele.

YOLA PCKATI KOKANA

"Owa pcpile tuu nale komeho gaantu oye-
ndji?" Osho Tangeni a pula Nangombe.
"Eeno" Nangombe ta yamukula. "Osho ni shio-
nde tile kandi na ondjo ya sha."

Omulongi gwosikola okwa pula aalongwa
ta ti: "omciwashike hatu ti aantu
mboka ya tokolelwa eso cyo aalu-
nde aakweyi?" Omulongwa gwe-
dhina Kamati okwa yamukula ta ti: "Om-
"Omciwashoka, aalunde mboka aayamba...
Ihaa tokolelwa eso".

Ehumokomeho nuukwashigwana

Nakunyola oshipopiwa shika tashi pukulula notashi gunu oshigwana, tate Iimmanuel Sh. Iithete okwi ilonga mUniveesiti ya Helsinki, moka a muno cnkatu, M. S C (Master of social Science). Meilongo lye okwa konakona wo iinima mtyoka yi nasha no-ntseyo yomikalo dhiigwana. Lesha ano nkene tate Iithete ta ndungike oshigwana, e to koneke.

Ehumckomeho neputuko oshinima oshiwanawa nosha pumbiwa, ihe pamwe nalyo chapu ya omapiyagano gi ili noji ili nosho wo omatumpakanitho nokuuvako pomambo. Olwindji miigwana ohamu holoka omaethopo giinima yontumba omilwokulundulukila mcmathimbo nomalongitho omape. Iinima yimwe oyo naanaa mtyoka oshigwana itashi vulu okukala shahe yina, oshcka oyi na ongushu onene koshigwana. Mevi lyetu mcmalunduluko gehumckomeho oga tameka pomimvo 1800 sho Aaeuropa ya thiki muka. Mongundu ndjika yAaeuropa omwa kwatelwa aalandithi, aakongc yoondjamba, aakolonyeki naahongi yochapu dhaKalunga.

Ekwatathano neendathano kehe lyiigwana yontumba, ohali eta aluhe omalunduluko gontumba. Gamwe omawanawa namgamwe omawinayi. Osha yela wo kutya kehe oshigwana oshinima omithigululwakalo dhasho moka omuntu to shi dhimbulula. Mcshigwana kehe, ngele shi kale pevi ngiini, omu na omikalo ndho omiwanawa tadhi vulu okulongithwa nokuhumithwa ashike komeho, ihe hakwekelwahi nonandc shi ye mehumckomeho lya tsa peni. Ope na wo omikalo omiwinayi mcmshigwana kehe tadhi pumbwa okweethiwa nenge okwoopalekwa, opo dhi longithwe.

Otu li muudhigu pethimbo lyetu, ndyoka

tatu ti olyehumckomeho. Omihoko dhetu ngee Aaherero, Awambo, nAdamara, otu na omithigululwakalo dhetu. Omikalo ngaashi dhokusimaneka aakuluntu ngaashi dhi li wo mcmikalo odhindji dhAayafrika. Omuntu oku na okukuutumba nenge ckutsa oongclo, uuna ta popitha omikuluntu nenge cmuyenda. Peha lyaashika Aaeuropa ohaa thikama uuna taya popitha aakuluntu. Pamukalo gwonale chaya tivula. Ngashingeyi omikalo nguka ohagu longithwa owala kaancna nokwaamboka ye li kcnimalela.

Ngashingeyi omikalo dhopashigwana otwe dhi etha po, unene tuu: aagundjuka naam-boka twa lesha, aniwa odhoshipaagani, nenge omiwinayi. Sho tatu longitha omikalo dhAaeuropa twe dhi ilonga mcmitse itaadhi zi mule womuntu, olyo nee e humckomeho ndyono nenge okweekelahi uukwashigwana nokutaamba uukwaEuropa nuukoloni?

Pakukonakcna ontseyo yomikalo dhopakelathano dhiigwana yi ili ncyi ili, onda dhimbulula kutya oshigwana kehe chashi dhimbululwa komithigululwakalo dhasho, omithigululwakalo ngaashi okusimaneka aakuluntu, omikalo dhomalongeloKalunga nomayakulo gaayenda. Oku na wo omikalo dhoondjimbo nodhomadhina gopashigwana kehe. Mcmikalo adhihe dhomevi lyetu namc wo omu na wo omadhina gcpashigwana.

Reagan - S.A.

Onkundana ya za muWashington otayi ti Ronald Reagan, omupresidente gwaAmerika okwe shi ulika sha yela kutya epangelo oya gama ku South Africa nolyiilongekidha oku mu kwatha, Shaa tuu oonkambadha ladhopa uyuki dhokukondjitha okatongc tadhishi tsikile.

Kakele kaBotha ngcka a taamba ko cma-dhiladhilo gaReagan normaako agehe, ope niwe natangc omalimbililo mshinima shika.

Ndcwishi lyokUuninginino ndyoka li na ekwatathano ewanawa na South Africa mii-pindi, oli li pe tali hala okudhenga m-dhalyo. Shika otashi etele aayambidhidhi yaReagan oluhodhi, oshoka otashi vulika shi fale sigc ometekcpe lyomakwatathano gopaudipoloma pokati kiilongc mbika iyali. Omukundu nguka gu li pokati kiilongc mbika otashi vulika wo gu kokele mo niilongc yilwe iinankndc yokUuninginino. Omukundu nguka otagu ka fala mepiyagano enene. Pahapu yoshifo: "The Sunday Mail", 10Maalitsa 1981, shika itashi ka etela nandc olye uuwanawa, kakele shila ka-SWAPO.

Oshifo nkundana shaZambia: "THE TIMES OF ZAMBIA", nasho wo osha hclola okulimbililwa omulandu gwepangelo lyaReagan noshe gu pangula. Oshifo shika osha ninga ethaneko opo omakwatathano gukuume niilongc yomuAfrica lyUuninginino ga talululwe ishewe. Ngashingeyi okwa ni-pgwa eindilo opo Nigeria na Saoedi-Arabia huli thepo egandjo lyawo lyomahocli kuAmerika, li longithwe ongcshike kondjitho shokukondjitha Reagan.

EYALULO LYAANTU

Eyalulo lyaantu lya longekidhwa lwotangc muNamibia, olya tseyithwa komuwiliki gwombelewa yom:apendulepo nom:atengeneko-faneko. Otali ka ningwa nuumvo, 26 Aguste. Eyalulo lyahugunina olya ningilwe muMei 1970. Ndika olya li lya longekidhwa muPre-toria.

Elongekidho lyeyalulo ndika lyonuumvo, o-lya tamekele mcmwedhi dhahugunina omumvo gwa ya 1980. Elalakano lyeyalulo ndika oku okumcra uyelele waantu yom:csilongc shika. Otaku ka longithwa ayaluli yethike lwopo 2000 naakwathi wo yalwe. Muushimba na palwe wo otaku ka endwa nom:cm:agumbo, ihe mOwambo otaku ka longelwa kumwe nomalenga nocyene yom:kunda mckugcngela t aantu.

Cofoclo ma dhokukuudhitha otadhi ka nyolwa mcmalaka gcpambelewa oshingilisa ncshimbulu, ihe omapul otaga ka nyolwa mcmalaka agehe gcmcsilongc.

* * * * *

dha za kep. 2

kcmkunda gwtango a ka paluthwe.

Esiku eti-15 lyaMaalitsa 1981, Iita okwa shashwa, edhina lye Ibsea Iita Ndagwedhapo yaTaangcna. Omusitagcngalo Markus Amushila neefolo lye cya taamba oshilonga shokuputudha Ibsea Iita Ndagwedhapo megumbc lyawo. Kalunga nahambelelwe, Iita a mcmno egumbo naaputudhi. Aathikameni ye peshasho cyo cm:diakoni Otto Ma-kkonen Egumbo neefolo lye mcm: Susanna Egumbo. Oshilonga shetumc osha Jesus mwene ngcka tati "Ondi li pamwe nane sigc ehulilo lyuuyuni Mat. 28:18-20

Cm:diakoni Otto M. Egumbo

Oombelewa yo pashinanena

Meiti -1973/1981 aantu ya konda 50, oya li ya gongala mcmzile gwokomatango gwe-tungc epeepeka pOniipa. Oyendji yomuyo aasitagongalo yomcshitayingeleka shC-ndcnga, mboka ya li noshigongi shawo mCniipa 17-20/3/1981.

Elalakano lyokugongala kwa tya ngeyi, olyokweegulula oombelewa dhoshitayingeleka shaNdcnga ndhoka dha tungwa pOniipa. Tate P. Shipena ngcka a egulula oshituthihambeleso shika, okwa holola nepandulo kutya oombelewa ndhika odha tungwa koshitayingeleka shoshene nopwaa na ekwatho lyayalwe. Tate Shipena sho a lesa meps. 147 newi lyuu udha omahambeleso, okwa hulitha negalikano.

shitopolwa oshitiyali shoshituthi: okulya nokuhwa. Manga omilema inadhi siikila evi, yo aantu oya halakana nale.

OMUTUNGILO GWCOMBELEWA

Omutungilo gwetungc ndika, orgaashika naanaa gwoombelewa dhongeleka naandhoka dhoshinyaryangidho. Etungc cli na omala (4). Omu na oombelewa yomutonateli, yaAmushanga, ela lyothitha nosho wo oombelewa yomahanganio galwe ngaashi osikola yOsocridaha, aagundjuka, nccmerre.

Etungc clya pula iimaliwa yi vule R10,000.00 Tate F. Ashipala, omutonatelishitayingeleka, okwa pandula omutungi, Heikki Mustaniemi, sho a shitulula elundu nokwe li ningi ondoclopa. Aantu sho ya pewa ompito yokutala meni lyoombelewa, oya yi mc-

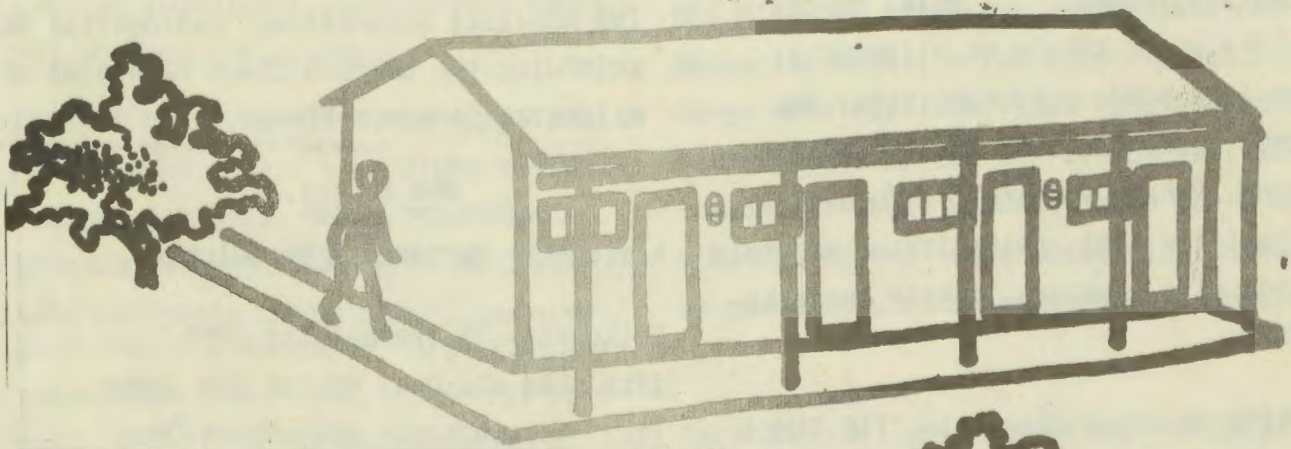

Methano ndika, otamu monika etungc mcka mu na oombelewa dha tumbulwa pombanda.

Omakende, omiyelo nokalupanda hoka^{ka}za kocombelewa dhongeleka, otayi monika methano ndika, ya tonata nawa.

OMUKWETU

Oye oshifo shOngoleka Onkwaevaangeli paLuther yomOwambokavange.

Ohashi nyanyangidhwa mOshinyanyangidho shOngoleka, ELOK, mOniipa.

Omukuluntu gwoshifo omumbisofi K.Dumeni.

Ondango yOmukwetu R2-60 komumvo muAfrica
Kombanda yomafuta R5-00. Omambestelo natumwe kOmukwetu.

Ev. Luth. Owambokavange Church Press
Private Bag 2013 Ondangwa 9000